

JIER

JZD ROLLER AND WHEEL FENDERS



Roller and used on the entrances, along the walls of dry docks and other restricted channels,



Wheel Fenders berth corners also widely



are commonly and dock installed

to help guide vessels and prevent hull damage.

These Fenders are commonly installed along the walls of dry docks and other restricted channels to help guide vessels and prevent hull damage. Roller Fenders are also used on berth corners and lock entrances where lower energy capacity is required. The wheel is mounted on a fixed axle supported by a special frame. Performance can be modified where required by adjusting the initial pressure. The heavy duty steel supporting frame is designed to allow easy access to all moving parts. Corrosion traps are eliminated, contributing to a low maintenance service life.

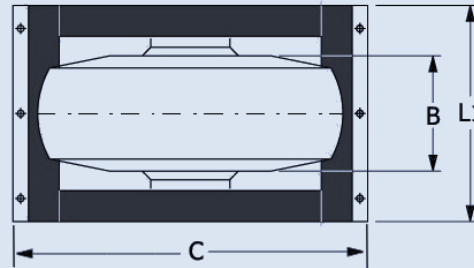
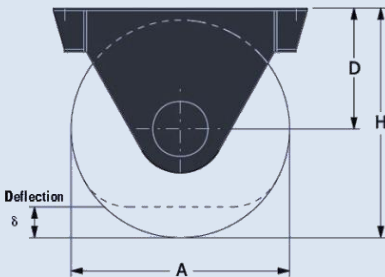

JZD Roller Fender Dimensions Table

Size	D1							D2		D3	
	A	B	C	D	L1	H	Weight (kg)	L1	Weight (kg)	L1	Weight (kg)
JZD600x200	600	200	695	320	420	620	128	770	245	1120	365
JZD750x250	750	250	870	400	510	775	248	935	501	1360	735
JZD900x300	900	300	1040	480	610	930	466	1120	878	1630	1291
JZD1200x400	1200	400	1380	640	820	1240	1046	1500	2041	2180	3005
JZD1500x500	1500	500	1740	800	1010	1550	2011	1850	3915	2690	5784
JZD1800x600	1800	600	2080	960	1210	1860	3443	2215	6701	3220	9891
JZD2100x700	2100	700	2440	1155	1410	2205	5612	2590	10925	3770	15895
JZD2400x800	2400	800	2770	1280	1610	2480	8116	2950	15701	4290	23300
JZD2700x900	2700	900	3130	1440	1810	2790	11595	/	/	/	/
JZD3000x1000	3000	1000	3480	1600	2010	3100	16011	/	/	/	/